

Installation instruction of AF321AC

Mounting Dimension

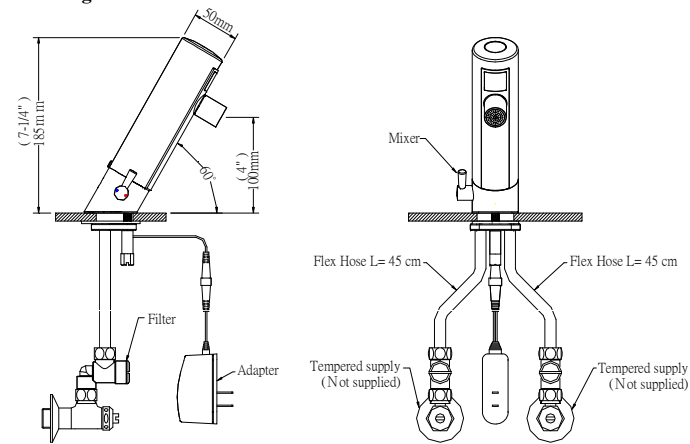

Specification

Model	AF321AC
Product	Electronic Faucet
Material of Casing	Chrome-plated brass casting
Power Apply	AC110V~AC220V 50/60 Hz
Power Consumption	5W below
Sensory Range	15cm (fixed)
Protection	Automatic flow stop after 1 minute in case of a continuous activation
Delay Time	0.5 - 1 second
Applicable water pressure	10-100 PSI
Flowing Volume	3.8L/min below
Applicable Water Temperature	39°F~150°F (4°C ~ 65°C)
Ceramic Bore Diameter	35Φ~45Φ (single-hole basin or deck)

Operation

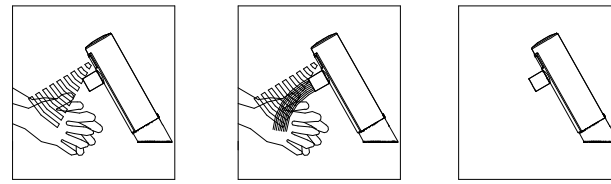

- The user's hands enter the sensor's range.
- The solenoid valve activates water flow and will continue until hands are moved away.
- After hands are moved away, the faucet automatically shuts off in 1 second.

Caution

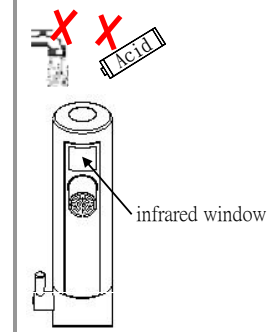

- Keep the infrared window clean at all times. Dirt and dust on the infrared window can cause sensor failure.
- Do not directly spray water or use strong acids to clean the casing as it may result in short-circuiting or clean the casing when necessary.
- Clean the filter regularly to avoid reduced water flow. This can be done as frequently as once every three months or as long as once every six months, depending on water quality.

Installation Steps

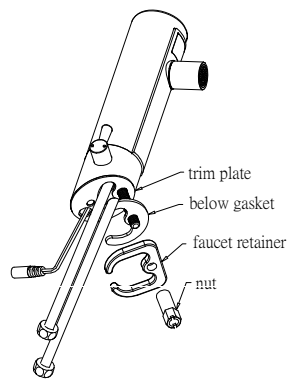
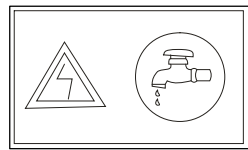

- (1) Remove nut, faucet retainer and below gasket. (keep trim plate)

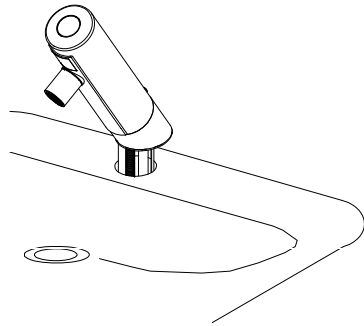

- (2) Secure faucet and trim plate on the upside of lavatory or deck's hole.

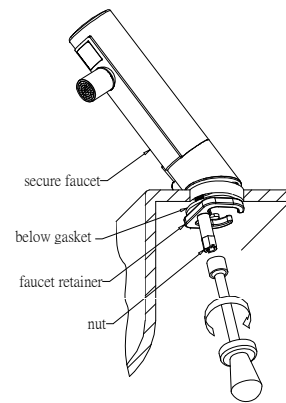

- (3) Firmly secure faucet by tools on the lavatory or deck.

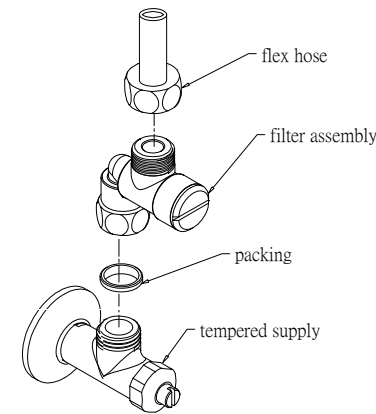

- (4) Turn on tempered supply to spout out dirty water with miscellaneous article.
- Firmly secure filter assembly by tools above tempered supply.
 - Fasten flex hose onto outlet of filter assembly.

※Remind to secure filter assembly to avoid faucet's abnormal activation.

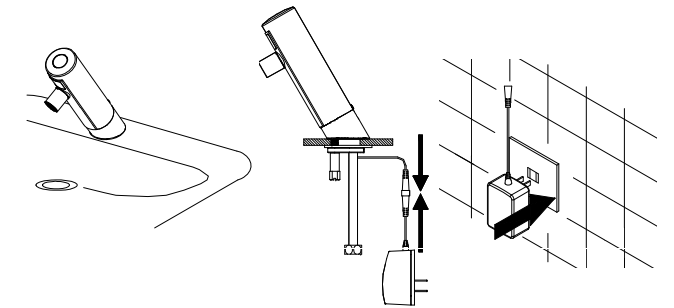

- (5) Electrified and watered in accordance with following steps.
- Connect adapter to faucet's power connector.
 - Connect power adapter and electric socket.
 - Turn on tempered supply and adjust to proper flow.

※Check electric power and water supply:

- Clean miscellaneous article inside of water pipe to avoid obstruction and faucet failure.

- Affirm specification of electric power and faucet model to avoid inflammation.

Clean filter assembly and flow adjustment

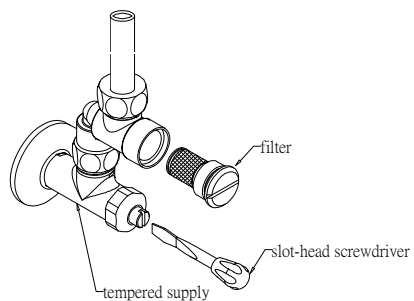

- Bad water quality resulted filter obstruction and flow decline. Turn off tempered supply by a slot-head screwdriver and take filter out for cleaning.

- Adjust proper flow by a slot-head screwdriver.

Temperature adjustment

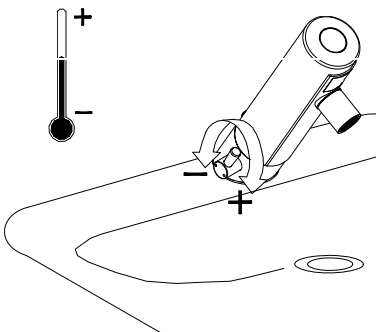

Adjust required temperature by mixer as above chart.

Troubleshooting

Situation	Possible Cause	Solution
No function(LED flashes)	1.dirty infrared window	wipe infrared window with tissues
No function(No LED lighting when in use)	1.electric power not connected	check for power connection
	2.control circuit failure	replace control circuit
No function (LED keeps blinking when in use)	1.water supply is turned off	check for water supply
	2.solenoid valve connector is loose	reconnect its connector
	3.solenoid valve failure	replace solenoid valve
	4.control circuit failure	replace control circuit
Water continuously running	1.dirty infrared window	wipe infrared window with tissues
	2.solenoid valve failure	replace solenoid valve or clean diaphragm
Low flow volume	1.low water supply	increase water supply
	2.filter obstructed	clean filter
	3.aerator obstructed	clean aerator
Abnormal spout	1.dirty infrared window	wipe infrared window with tissues

Spare parts

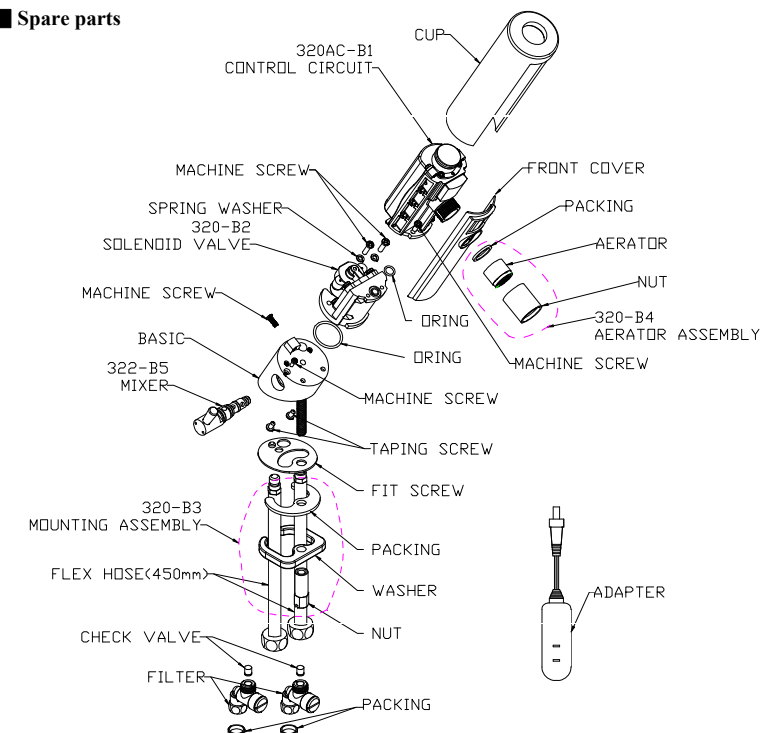

Installation Instruction of AF321DC

Mounting Dimension

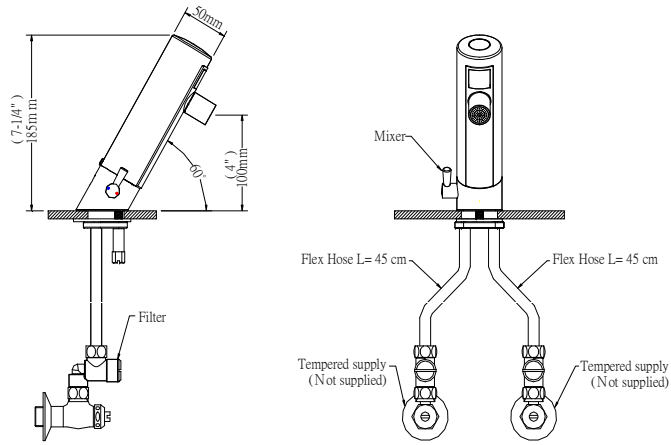

Specification

Model	AF321DC
Product	Electronic Faucet
Material of Casing	Chrom-plated brass casting
Power Apply	Size AA Alkaline battery x 4pcs
Power Consumption	3W below
Sensory Range	15cm (fixed)
Protection	Automatic flow stop after 1 minute in case of a continuous abnormal flow
Delay Time	0.5 - 1 second
Applicable water pressure	10-100 PSI
Flowing volume	3.8L/min below
Applicable water temperature	39°F~150°F (4°C ~ 65°C)
Ceramic bore diameter	35Φ~45Φ (single-hole basin or deck)

Operation

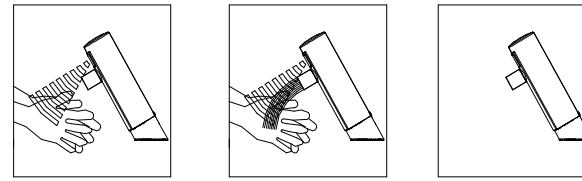

1. The user's hands enter the sensor's range.
2. The solenoid valve activates water flow and will continue until hands are moved away.
3. After hands are moved away, the faucet automatically shuts off in 1 second.

Caution

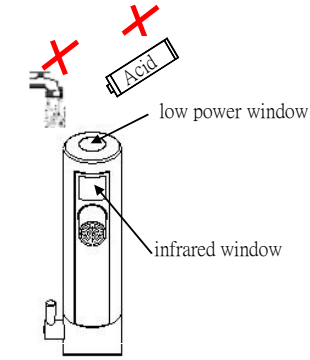

1. Keep the infrared window clean all times. Dirt and dust on the infrared window can cause sensor failure.
2. Do not directly spray water or use strong acids to clean the casing as it may result in short-circuiting or clean the casing when necessary.
3. Clean the filter regularly to avoid reduced water flow. This can be done as frequently as once every three months or as long as once every six months, depending on water quality.
4. The faucet applied for alkaline battery, replace new battery when LED flashes at the upside window.

Installation Steps

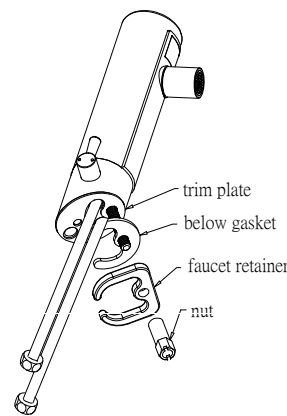
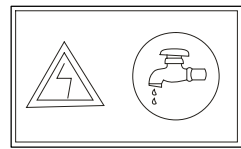

- (1) Remove nut, faucet retainer and below gasket. (keep trim plate)

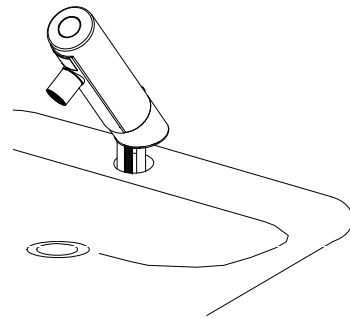

- (2) Secure faucet and trim plate on the upside of lavatory or deck's hole.

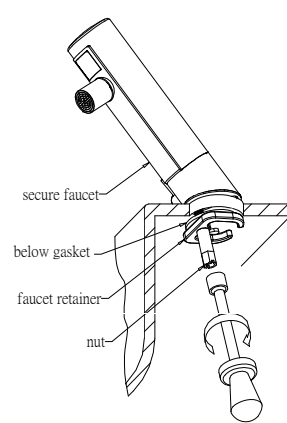

- (3) Firmly secure faucet by tools on the lavatory or deck.

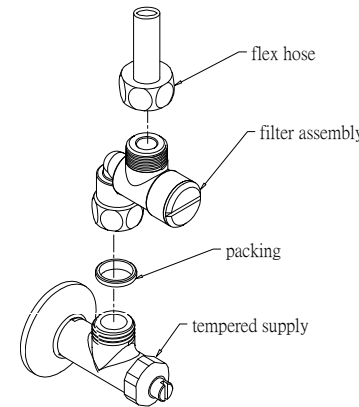

- (4) Turn on tempered supply to spout out dirty water with miscellaneous article.
 1. Firmly secure filter assembly by tools above tempered supply.
 2. Fasten flex hose onto outlet of filter assembly.

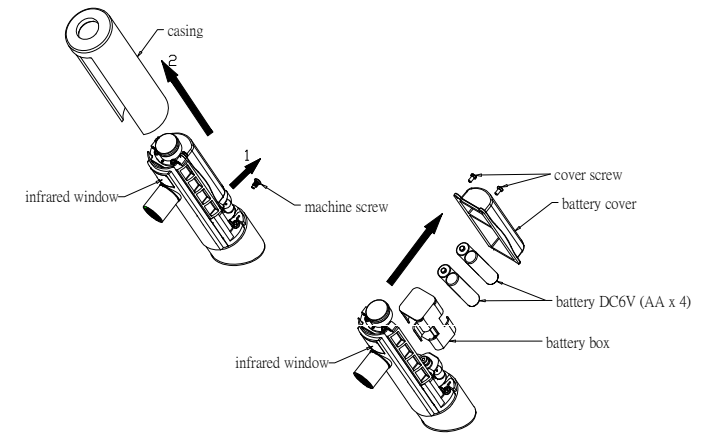

- (5) Remove casing and battery box in accordance with above charts.
 1. Install battery DC1.5V AA x 4 accordingly.
 2. Secure battery box and casing in opposite sequence.
 3. Turn on tempered supply and adjust to proper flow.

※Check electric power and water supply:
· Clean miscellaneous article inside of water pipe to avoid obstruction and faucet failure.

※Remind to secure filter assembly to avoid faucet's abnormal activation.

Clean filter and flow adjustment

Battery replacement

Temperature adjustment

Troubleshooting

Spare parts

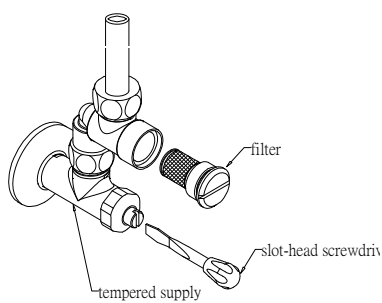

1. Bad water quality resulted filter obstruction and flow decline. Turn off tempered supply by a slot-head screwdriver and take filter out for cleaning.
2. Adjust proper flow by a slot-head screwdriver.

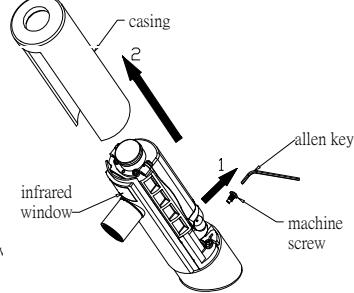

The faucet applied for alkaline battery, please replace new battery when LED flashes at the upside window indicator.

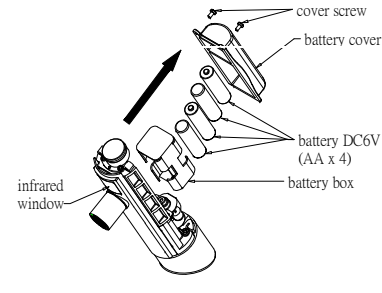

- Procedure of battery replacement:
1. Remove fasten screws by an Allen key.
 2. Remove casing and battery box in sequence.
 3. Replace 4xDC1.5V(AA) Battery.
 4. Secure battery box and casing in opposite sequence.
 5. Fasten screws by an Allen key.

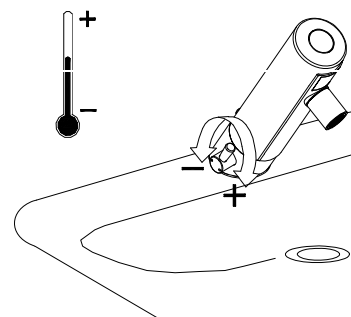

Adjust required temperature by mixer as above chart.

Situation	Possible Cause	Solution
No function (LED flashes)	1. dirty infra	wipe sensor window with tissue paper
	2. lower battery	replace battery
No function (No LED flashes)	1. lower battery	replace battery
	2. control circuit failure	replace circuit
No function (LED flashes when using)	1. water supply is turned off	check for water supply
	2. solenoid valve connector is loose	reconnect its connector
	3. solenoid valve failure	replace solenoid valve
	4. control circuit failure	replace control circuit
Water continuously running	1. dirty infrared window	wipe sensor window with tissue paper
	2. solenoid valve failure	replace solenoid valve or clean diaphragm
Low flow volume	1. low water supply	increase water supply
	2. filter obstructed	clean filter
	3. aerator obstructed	clean aerator
Water flow too weak	1. dirty infrared window	wipe sensor window with tissue paper

