

## Installation Instruction for AF320AC

### ■ Mounting Dimension

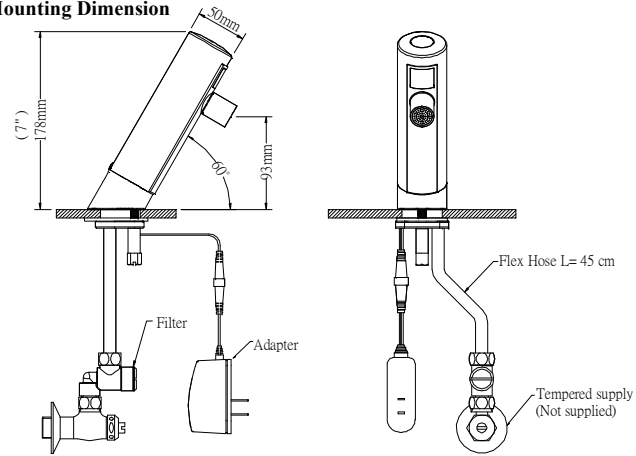

### ■ Specification

<b>Model</b>	AF320AC
<b>Product</b>	Electronic Faucet
<b>Material of Casing</b>	Chrome-plated brass casting
<b>Power Apply</b>	AC110V~AC220V 50/60 Hz
<b>Power consumption</b>	5W below
<b>Infrared Sensor Range</b>	15cm (fixed)
<b>Protection</b>	Automatic flow stop after 1 minute in case of a continuous abnormal flow
<b>Delay Time</b>	0.5 - 1.0 seconds
<b>Applicable Water Pressure</b>	10-100 PSI
<b>Flowing Volume</b>	3.8L/min below
<b>Applicable Water Temperature</b>	39°F~150°F (4°C ~ 65°C)
<b>Ceramic Bore Diameter</b>	28Φ~ 45Φ (single-hole basin or deck)

### ■ Operation

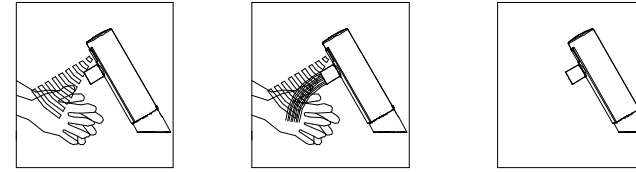

1. The user's hands enter the sensor's range.
2. The solenoid valve activates water flow and will continue until hands are moved away.
3. After hands are moved away, the faucet automatically shuts off in 1 second.

### ■ Caution

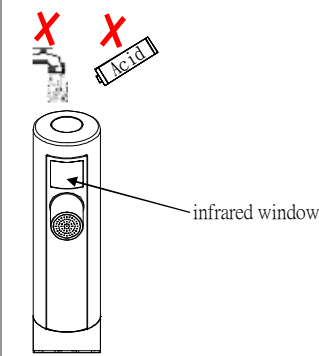

1. Keep the infrared window clean a all times. Dirt and dust on the infrared window can cause sensor failure.
2. Do not directly spray water or use strong acids to clean the casing as it ma result in short-circuiting or clean the casing when necessary.
3. Clean the filter regularly to avoid reduced water flow. This can be done as frequently as once every three months or as long as once every six months, depending on water quality.

### ■ Installation Steps

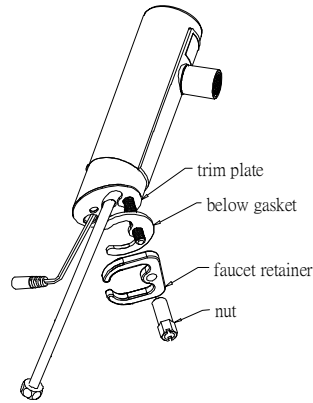
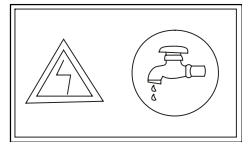

- (1) Remove nut, faucet retainer and below gasket. (keep trim plate)

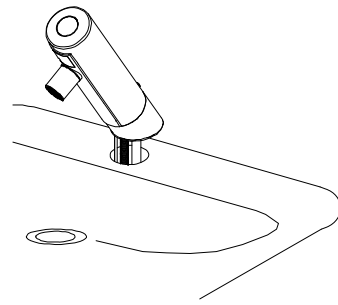

- (2) Secure faucet and trim plate on the upside of lavatory or deck's hole.

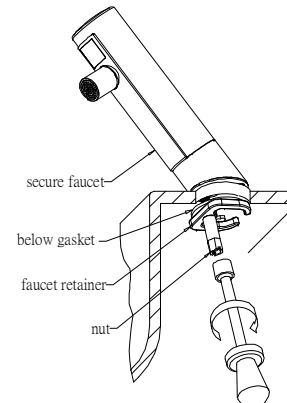

- (3) Firmly secure faucet by tools on lavatory or deck.

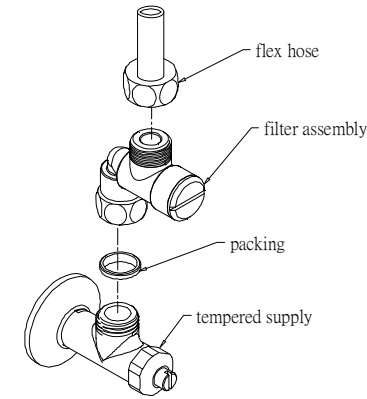

- (4) Turn on tempered supply to spout out dirty water with miscellaneous article.
  1. Firmly secure filter assembly by tools above tempered supply.
  2. Fasten flex hose onto outlet of filter assembly.

※Remind to secure filter assembly to avoid faucet's abnormal activation.

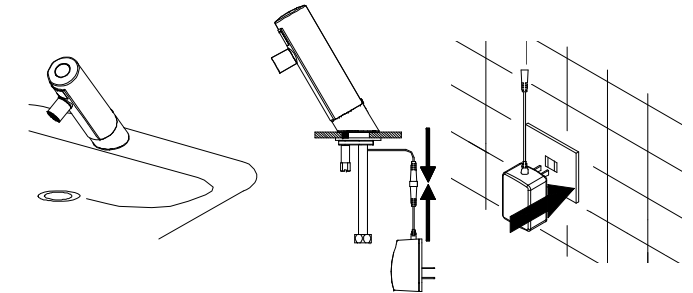

- (5) Electrified and watered in accordance with following steps.
  1. Connect adapter to faucet's power connector.
  2. Connect power adapter and electric socket.
  3. Turn on tempered supply and adjust to proper flow.

※Check electric power and water supply:  
 · Clean miscellaneous article inside of water pipe to avoid obstruction and faucet failure.

· Affirm specification of electric power and faucet model to avoid inflammation.

### ■ Clean filter assembly

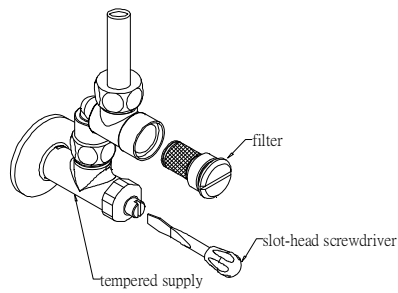

Bad water quality resulted filter obstruction and flow decline. Turn off tempered supply by a slot-head screwdriver and take filter out for cleaning.

### ■ Flow adjustment

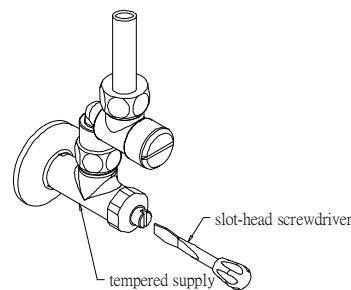

Adjust flow volume by a slot-head screwdriver.

### ■ Troubleshooting

Situation	Possible Cause	Solution
No function (LED flashes)	1. dirty infrared window	wipe infrared window with tissues
No function (No LED lighting when using)	1. electric power not connected	check for power connection
	2. control circuit failure	replace control circuit
No function (LED keeps blinking when in use)	1. water supply is turned off	check for water supply
	2. solenoid valve connector is loose	reconnect its connector
	3. solenoid valve failure	replace solenoid valve
	4. control circuit failure	replace control circuit
Water continuously running	1. dirty infrared window	wipe infrared window with tissues
	2. solenoid valve failure	replace solenoid valve or clean diaphragm
Low flow volume	1. low water supply	increase water supply
	2. filter obstructed	clean filter
	3. aerator obstructed	clean aerator
Abnormal spout	1. dirty infrared window	wipe infrared window with tissues

### ■ Spare parts

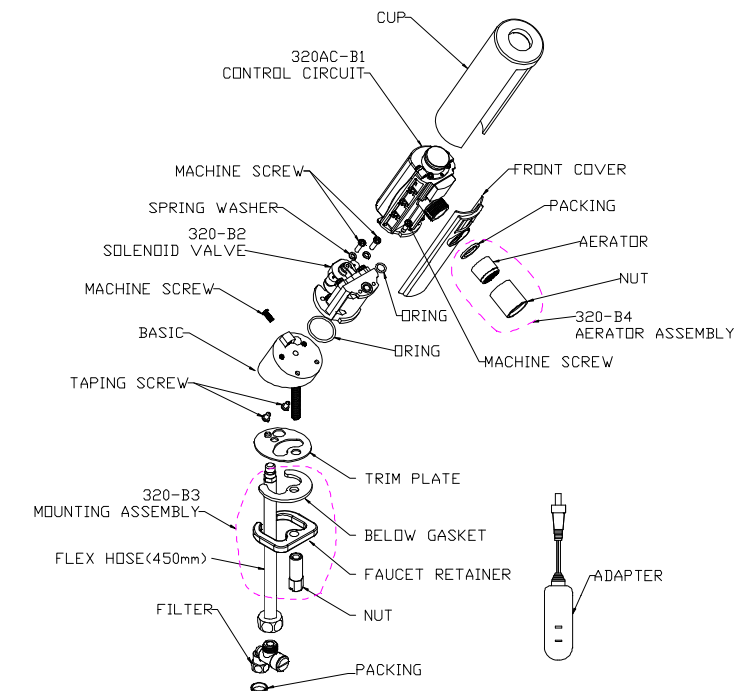

# Installation Instruction for AF320DC

## Mounting Dimension

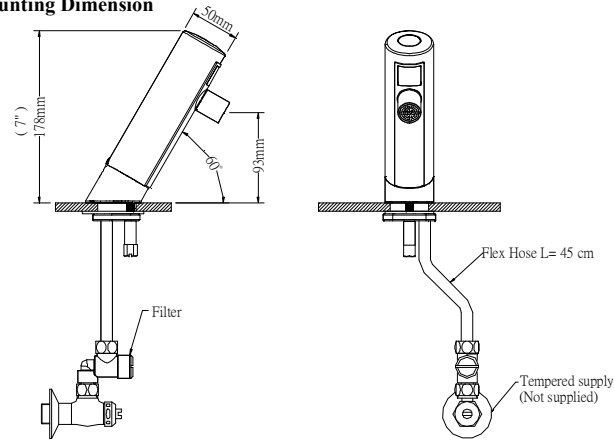

## Specification

Model	AF320DC
Product	Electronic Faucet
Material of casing	chrome-plated brass casting
Power Apply	Size AA Alkaline battery x 4pcs
Power Consumption	3W below
Infrared Sensor Range	15cm (fixed)
Protection	Automatic flow stop after 1 minute in case of a continuous abnormal flow
Delay Time	0.5 - 1.0 seconds
Applicable water pressure	10-100 PSI
Flowing volume	3.8L/min below
Applicable water temperature	39°F~150°F (4°C ~ 65°C)
Ceramic Bore Diameter	28Φ~45Φ (single-hole basin or deck)

## Operation

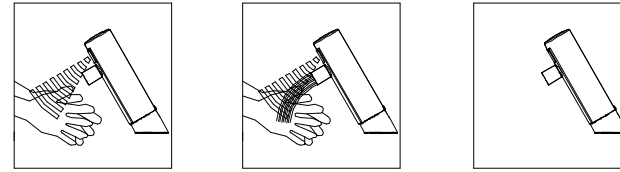

1. The user's hands enter the sensor's range.
2. The solenoid valve activates water flow and will continue until hands are moved away.
3. After hands are moved away, the faucet automatically shuts off in 1 second.

## Caution

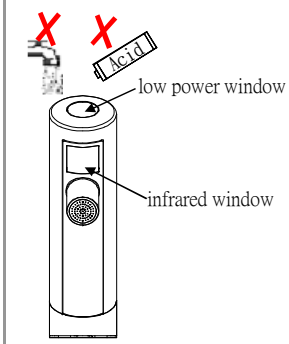

1. Keep the infrared window clean all times. Dirt and dust on the infrared window can cause sensor failure.
2. Do not directly spray water or use strong acids to clean the casing as it may result in short-circuiting or clean the casing when necessary.
3. Clean the filter regularly to avoid reduced water flow. This can be done as frequently as once every three months or as long as once every six months, depending on water quality.
4. The faucet applied for alkaline battery, replace new battery when LED flashes at the upside window indicator.

## Installation Steps

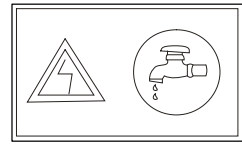

- ※ Check electric power and water source
- Clean miscellaneous article inside of water pipe to avoid obstruction and faucet failure.
- Affirm specification of electric power and faucet model to avoid inflammation.

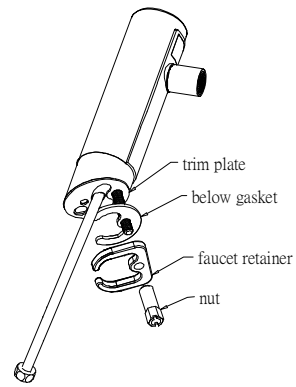

- (1) Remove nut, faucet retainer and below gasket. (keep trim plate)

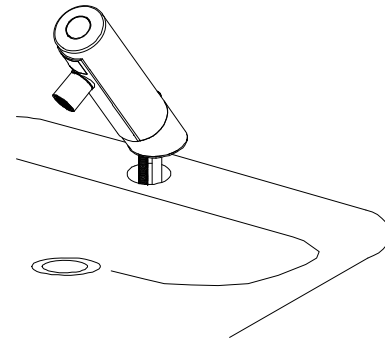

- (2) Secure faucet and trim plate on the upside of lavatory or deck's hole.

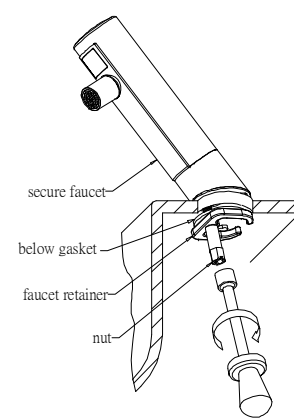

- (3) Firmly secure faucet by tools on lavatory or deck.

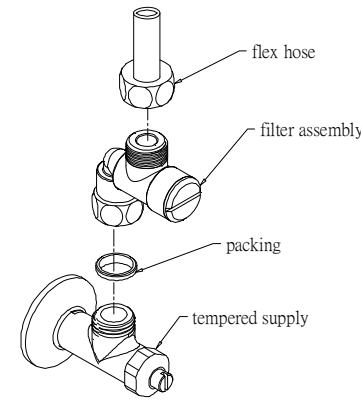

- (4) Turn on tempered supply to spout out dirty water with miscellaneous article.
1. Firmly secure filter assembly by tools above tempered supply.
  2. Fasten flex hose onto outlet of filter assembly.

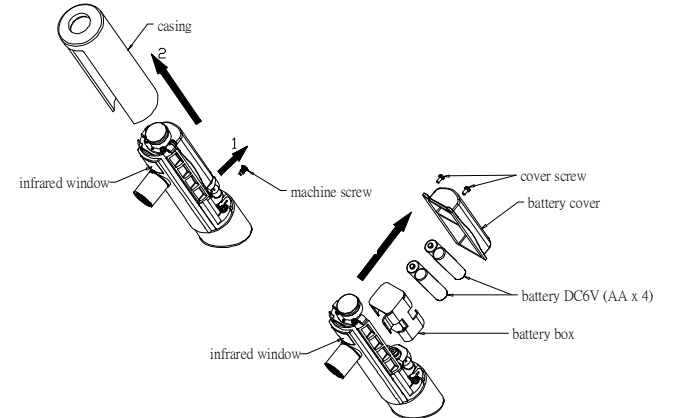

- (5) Remove casing and battery box in accordance with above charts.
1. Install battery DC1.5V AA x 4 accordingly.
  2. Secure battery box and casing in opposite sequence.
  3. Turn on tempered supply and adjust to proper flow.

※ Remind to secure filter assembly to avoid faucet's abnormal activation.

## Clean filter and flow adjustment

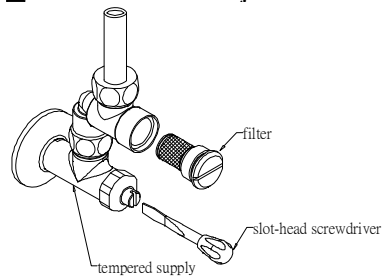

1. Bad water quality resulted filter obstruction and flow decline. Turn off tempered supply by a slot-head screwdriver and take filter out for cleaning.
2. Adjust proper flow by a slot-head screwdriver.

## Battery replacement

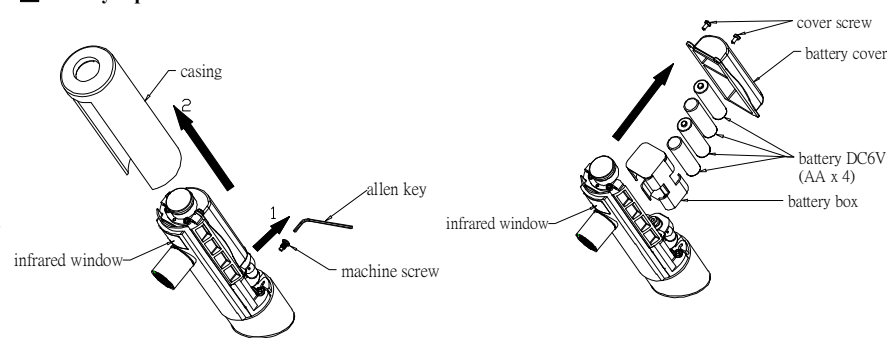

- Battery replacement**  
The faucet applied for alkaline battery, please replace new battery when LED flashes at the upside window indicator.

- Procedure of battery replacement:
1. Remove fasten screws by an Allen key.
  2. Remove casing and battery box in sequence.
  3. Replace 4xDC1.5V(AA) Battery.
  4. Secure battery box and casing in opposite sequence.
  5. Fasten screws by an Allen key.

## Troubleshooting

Situation	Possible Cause	Solution
No function (LED flashes)	1. dirty infrared window	wipe sensor window with tissue paper
	2. lower battery	replace battery
No function (No LED flashes)	1. lower battery	replace battery
	2. control circuit failure	replace circuit
No function (LED flashes when using)	1. water supply is turned off	check for water supply
	2. solenoid valve connector is loose	reconnect its connector
	3. solenoid valve failure	replace solenoid valve
	4. control circuit failure	replace control circuit
Water continuously running	1. dirty infrared window	wipe sensor window with tissue paper
	2. solenoid valve failure	replace solenoid valve or clean diaphragm
Low flow volume	1. low water supply	increase water supply
	2. filter obstructed	clean filter
	3. aerator obstructed	clean aerator
Water flow too weak	1. dirty infrared window	wipe sensor window with tissue paper

## Spare parts

